

Location of Man holes on  
21st St.

Station 76+69<sup>88</sup> = Center of Man hole

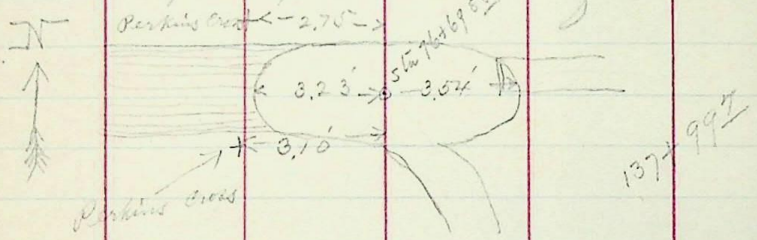

Sta 74+00<sup>28</sup> = Center of Man hole Cover

" 74+01<sup>83</sup> = East Crown of Arch.

Sta 71+10<sup>86</sup> = Center of Man hole (Point on)

" 71+12<sup>84</sup> = East Crown of Arch.

Sta 66+99<sup>83</sup> = Center of Man hole Cover

" 67+01<sup>46</sup> = East Crown of Arch.

Sta 63+21<sup>96</sup> = Center of Man hole Cover

" 63+24<sup>03</sup> = East Crown of Arch.

P.M.  
Dec 1<sup>st</sup> 1890.

Set Stakes for Invert Grade in  
Sewer on Hall Ave. from Sta 115+30  
to Sta 113+50

A.M. Dec 2-90

Set Stakes to 10.0ft above grade for  
Pipe on 2<sup>nd</sup> St from Station

87 to Sta 89+40

A.M. Dec 2-90